

**ART. 99 RAGNO / SPIDER SPINNE**

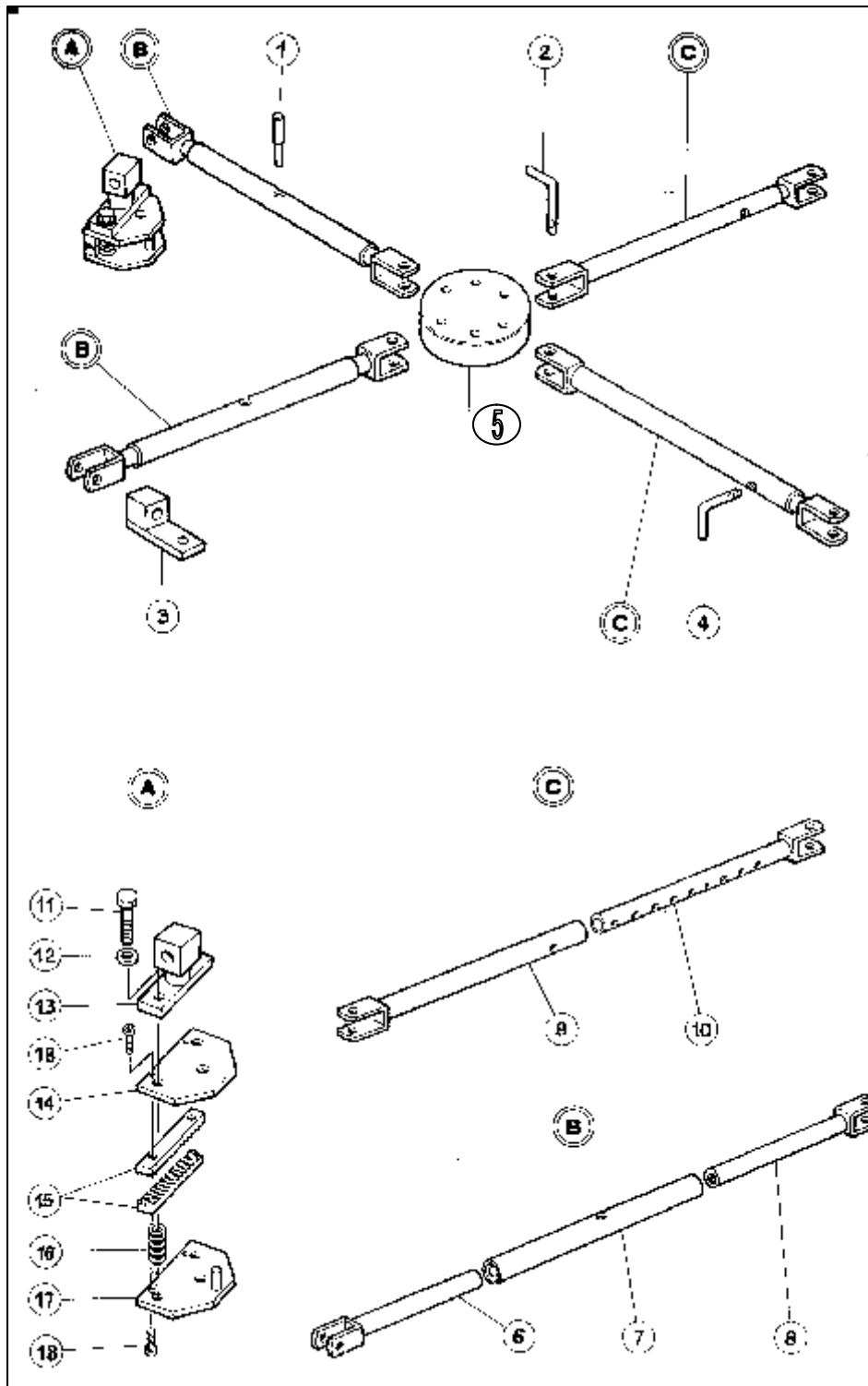

**ART. 99 RAGNO / SPIDER SPINNE**

<b>POS.</b>	<b>Q.TA'</b>	<b>CODICE</b>	<b>DENOMINAZIONE</b>	<b>DIMEN.</b>	
			<b>DESIGNATION</b>	<b>SIZES</b>	
			<b>BEZEICHUNG</b>		
1	1	<b>D5050400</b>	PERNO		
2	8	<b>A5051300</b>	PERNO DI FERMO COMP.	D. 14	
3	2	<b>A6021500</b>	STAFFA SNODATA		
4	2	<b>A5051400</b>	PERNO DI FERMO COMP.	D.10	
5	1	<b>D6030400</b>	SUPPORTO CENTRALE RAGNO		
6	2	<b>A0510700</b>	BRACCIO MOB. SX COMP.		
7	2	<b>A4020200</b>	MANICOTTO COMPLETO		
8	2	<b>A0510800</b>	BRACCIO MOB.DX COMP.		
9	2	<b>A4020300</b>	MANICOTTO INNESTO		
10	2	<b>A0510900</b>	BRACCIO INNESTO		
11	8	<b>C0000124</b>	VITE TE	M. 12*60	
12	8	<b>C0006512</b>	RONDELLA	D. 12	
13	4	<b>A6021400</b>	STAFFA SNODATA 2 FORI		
14	4	<b>D5030800</b>	PIASTRA PORTA GANASCE		
15	8	<b>D4030100</b>	MORSETTINI		
16	8	<b>D4040100</b>	MOLLA		
17	4	<b>A5034100</b>	PIASTRA DI RISCONTRO		
18	16	<b>C0001010</b>	VITE TCEI	M. 6*10	